

# Bluetooth® Data Logger

## TR4 Series Features and Specs

|  |   |  |                                     |
|--|---|--|-------------------------------------|
| <b>Measurement Item</b><br>Temperature | <b>Data Collection</b><br>Smart phone/Tablet<br>( via Bluetooth ) | <b>Data Access</b><br>Smart phone/Tablet<br>WebStorage Service | <b>Warning Notification</b><br>None |
|--|---|--|-------------------------------------|

TR4 series temperature data loggers come equipped with Bluetooth low energy technology. We have designed two dedicated apps to take advantage of this technology. “ThermoREC” with automatic refresh allows for real-time monitoring of important temperature changes. “ThermoStorage” enables the uploading of recorded data from a collection of loggers to our free cloud storage service “T&D WebStorage Service”.

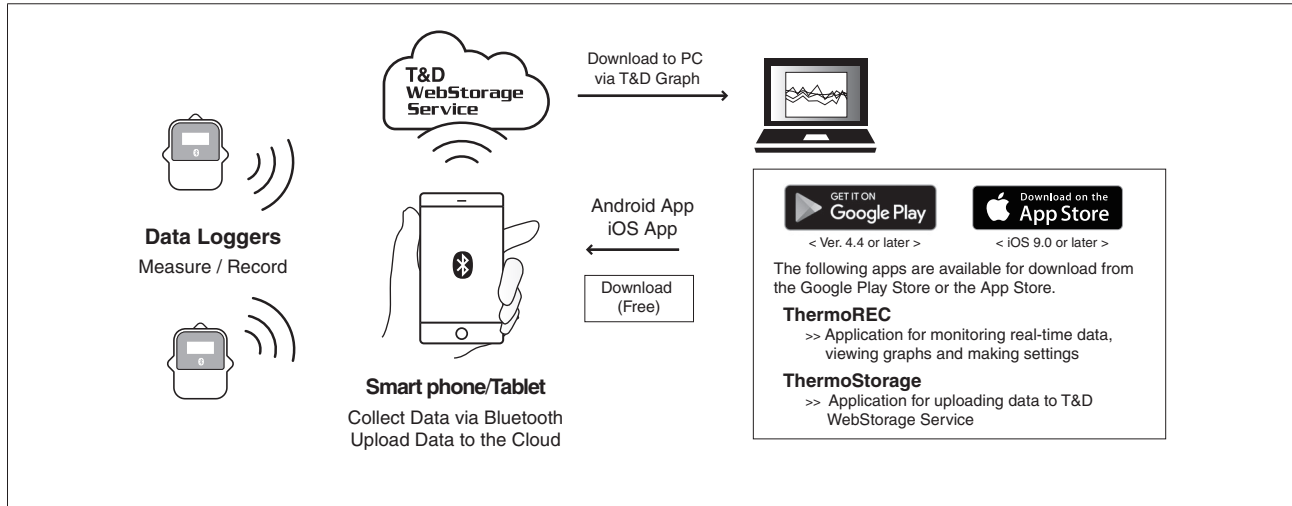

| Model Number | Measurement Item                                     | Measurement Range            | Notes   |
|--------------|--|------------------------------|---|
| TR41         | Temperature 1ch (Internal Sensor)                    | -40 to 80 °C                 | Gradual Response Time<br>Immersion Proof  |
| TR42         | Temperature 1ch (External Sensor)                    | -60 to 155 °C                | Quick Response External Sensor (included)<br>Splash Proof (rated for use in daily life)<br>Wide Selection of Optional Sensors |
| TR45         | Temperature 1ch (Thermocouple / Pt sensor supported) | Thermocouple -199 to 1760 °C | For use with Thermocouple Sensor Types: K, J, T, S, R   |
|              |  | Pt -199 to 600 °C            | Supports 3-wire & 4-wire Pt 100/1000 Sensor<br>Optional Pt100 sensors with selectable pipe dimensions and cable lengths       |

### Common Features

#### Bluetooth Connection with Smartphone

Bluetooth allows easy communication between mobile devices and loggers in range. Use the dedicated apps for real-time monitoring, graphs and auto-upload. Uploaded data can be shared via our free cloud service “T&D WebStorage Service”.

#### 15 Recording Intervals and Large Logging Capacity for Long-Term Recording

One logger can measure and record up to 16000 readings. Select from 15 recording interval choices from 1 second to 60 minutes. If set at a 60-minute recording interval, that gives you 666 days of non-stop consecutive recording.

### TR45 Features

#### Each Logger is both Thermocouple/Pt Sensor Compatible

The screw terminals on the back of the data logger make it possible to connect either Thermocouple or Pt sensors.

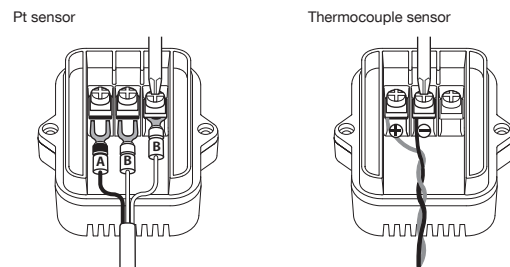

\* The Bluetooth® word mark and logos are registered trademarks owned by Bluetooth SIG, Inc. and any use of such marks by T&D Corporation is under license.

## TR4 Series Specifications

|                          | TR41   | TR42   | TR45   |  |
|--------------------------|--|--|--|--|
| Measurement Channels     | Temperature 1ch  | Temperature 1ch  | Temperature 1ch  |  |
| Sensor                   | Thermistor (Internal)  | Thermistor (External)  | Thermocouple Type K, J, T, S, R  | Pt100, Pt1000 3-wire, 4-wire (*1)  |
| Measurement Units        | °C, °F   | °C, °F   | °C, °F   |  |
| Measurement Range        | -40 to 80 °C   | -60 to 155 °C  | K -199 to 1370 °C<br>J -199 to 1200 °C<br>T -199 to 400 °C<br>S -50 to 1760 °C<br>R -50 to 1760 °C   | -199 to 600 °C   |
| Accuracy                 | Avg. ± 0.5 °C  | Avg. ± 0.3 °C at -20 to 80 °C<br>Avg. ± 0.5 °C at -40 to -20 °C<br>80 to 110 °C<br>Avg. ± 1.0 °C at -60 to -40 °C<br>110 to 155 °C   | Thermocouple Measurement (Sensor inaccuracies not included)<br>K, J, T : ±(0.5 °C + 0.3 % of reading) at -100°C or above<br>S, R : ±(1.5 °C + 0.3 % of reading) at 100°C or above<br>Cold Junction Compensation ±0.5 °C *at 10 to 40 °C<br>±0.8 °C *at -40 to 10 °C, 40 to 80 °C | ±(0.3 °C + 0.3 % of reading) *at 10 to 40 °C<br>±(0.5 °C + 0.3 % of reading) *at -40 to 10 °C, 40 to 80 °C |
| Measurement Resolution   | 0.1 °C   | 0.1 °C   | K, J, T 0.1 °C<br>S, R 0.2 °C  | 0.1 °C   |
| Responsiveness           | Thermal Time Constant: Approx. 15 min.<br>Response Time (90%): about 35 minutes                          | Thermal Time Constant: Approx. 30 sec. (in air)<br>Approx. 4 sec. (in agitated water)<br>Response Time (90%): Approx. 80 sec. (in air)<br>Approx. 7 sec. (in agitated water) | -  | -  |
| Logging Capacity         | 16,000 readings  |  |  |  |
| Recording Interval       | Select from 15 choices: 1, 2, 5, 10, 15, 20, 30 sec. or 1, 2, 5, 10, 15, 20, 30, 60 min.                 |  |  |  |
| Recording Mode           | Endless (Overwrite oldest data when capacity is full) or One Time (Stop recording when capacity is full) |  |  |  |
| LCD Display Items        | Measurements, Recording Status, Battery Life Warning, etc.   |  |  |  |
| Communication Interfaces | Bluetooth 4.1 (Bluetooth low energy)   |  |  |  |
| Power                    | Lithium Battery LS14250 x 1  |  |  |  |
| Battery Life (*2)        | Approx. 1 month (*3) to 1.5 years (*4)   |  | Approx. 1 month (*3) to 1 year (*4)  |  |
| Dimensions               | H 62 mm x W 47mm x D 19 mm   |  | H 62 mm x W 47mm x D 26.5 mm   |  |
| Weight                   | Approx. 45 g   |  | Approx. 50 g   |  |
| Operating Environment    | Temperature -40 to 80°C<br>-25 to 80°C during wireless communication                                     |  | Temperature -40 to 80°C<br>-25 to 80°C during wireless communication<br>Humidity 90 %RH or less (no condensation)  |  |
| Waterproof Capacity      | IP67: Immersion proof  | IP64: Splash proof (rated for use in daily life) (*5)  | None   |  |
| Accessories              | -  | Temperature Sensor TR-5106   | Cable Clamp  |  |
| Data Collection Devices  | Smartphone, Tablet   |  |  |  |

\*1: In the case of a 4-wire sensor, one wire will be left unused.

\*2: Battery life varies depending upon multiple factors including ambient temperature, recording interval, usage of applications, and battery performance. All estimates are based on operations carried out with a new battery and are in no way a guarantee of actual battery life.

\*3: Estimated minimum battery life when recording data at an interval of 1 second and constant graph display in the app.

\*4: Estimated maximum battery life when recording data at an interval of more than 10 seconds and graph display in the app of less than 3 minutes a day.

\*5: This is the waterproof capacity of the data logger with the sensor connected.

The specifications listed above are subject to change without notice.